

RB327N4BWE

Hisense

Freestanding fridge/freezer, White, 256 L



Fresh Crisper



Total No Frost



Super Cool



Precise Electronic Control



Counter Depth

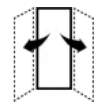

Reversible Door



A-Rated - Energy Efficiency



High-level energy class



Chrome Wine Rack



Safety Glass Shelves



Low Noise



LED Display

General information

Construction type:	Freestanding	Energy efficiency class:	E
Noise class:	C	Location of freezing compartment:	Below
Colour of appliance:	White	Door colour:	White
Door material:	Varnished	Door opening:	Right reversible
Number of doors:	2	Type of base:	2 adjustable feet
Climate classes:	Subnormal, Normal, Subtropic		

Efficiency

Total volume:	256 L	Capacity of cooling compartment:	171 L
Capacity of freezer compartment:	85 L	Freezing capacity in 24 hours:	5 kg
Power cut safe time:	13 h	Annual energy consumption (Aec):	226 kWh

Control

Type of display:	LED display	Control type:	Electronic
Temperature indicator:	Digital temperature indicator for freezer and refrigerator	Cooling compartment defrost mode:	Automatic
Freezing compartment defrost mode:	Automatic		

Features

No Frost:	Total No frost	Air movement:	Multi Air Flow
Eco Mode:	Yes		

Equipment of refrigerator

Water dispenser:	No	Bottle holder:	Wine Rack
Home Bar:	No	Trays in refrigerator door:	3 door trays
Fridge compartment illumination:	LED strip on ceiling	Ice maker:	No
Number of glass shelves in fridge compartment:	3 pcs	Cellar (0 zone):	Fresh Crisper

Equipment of freezer

Ice tray:	1 classic	Ice cube tray:	No
Freezing compartment:	3 drawers, 1 tray	Freezer compartment illumination:	Without illumination

Number of glass shelves in freezer compartment: **1 pcs**

Technical data

Noise level (max): **37 dB(A)**

Number of compressors: **1 compressor**

Water supply: **No**

Type of refrigerant: **R600A**

Number of independent cooling systems: **1**

Width of the product: **550 mm**

Height of the product: **1824 mm**

Depth of the product: **557 mm**

Gross weight: **54 kg**

Net weight: **50 kg**

Width of the packed product: **580 mm**

Height of the packed product: **1887 mm**

Depth of the packed product: **580 mm**

Voltage: **220-240 V**

Product code: **20011080**

EAN code: **6921727066220**
