

RB435N4BFE

Hisense

Freestanding fridge/freezer, Black, 336 L



Fresh Crisper



Moisture Fresh Crisper



Precise Electronic Control



Counter Depth

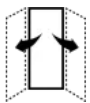

Reversible Door



A-Rated - Energy Efficiency



High-level energy class



Chrome Wine Rack



XXL Door Balcony



Safety Glass Shelves



Low Noise



LED Display

General information

| | | | |
|----------------------|---------------------------|-----------------------------------|---|
| Construction type: | Freestanding | Energy efficiency class: | E |
| Noise class: | C | Location of freezing compartment: | Below |
| Colour of appliance: | Black | Door colour: | Black Steel |
| Door material: | Colaminated steel | Door opening: | Right reversible |
| Number of doors: | 2 | Type of base: | 4 wheels /2 adjustable feet in front |
| Star rating: | Fresh food, 4-star | Climate classes: | Subtropic, Normal, Subnormal |

Efficiency

| | | | |
|----------------------------------|--------------|----------------------------------|----------------|
| Total volume: | 336 L | Capacity of cooling compartment: | 238 L |
| Capacity of freezer compartment: | 98 L | Freezing capacity in 24 hours: | 6 kg |
| Power cut safe time: | 10 h | Annual energy consumption (Aec): | 247 kWh |

Control

| | | | |
|-----------------------------------|--------------------|------------------------------------|-----------------------------------|
| Type of display: | LED display | Control type: | Electronic behind the door |
| Cooling compartment defrost mode: | Automatic | Freezing compartment defrost mode: | Automatic |

Features

| | | | |
|---------------------------------|--|-----------|------------|
| Crisper pan humidity regulator: | CrispZone drawer with HumidityControl | Eco Mode: | Yes |
|---------------------------------|--|-----------|------------|

Equipment of refrigerator

| | | | |
|--|---------------------|----------------------------------|---|
| Bottle holder: | Wine Rack | Door bottle container: | 1 single container without stopper |
| Trays in refrigerator door: | 3 door trays | Fridge compartment illumination: | LED strip on ceiling |
| Number of glass shelves in fridge compartment: | 4 pcs | Cellar (0 zone): | Fresh Crisper |

Equipment of freezer

| | | | |
|-----------------------------------|-----------------------------|-----------------------|------------------|
| Ice tray: | 1 classic | Freezing compartment: | 3 drawers |
| Freezer compartment illumination: | Without illumination | | |

Technical data

| | | | |
|----------------------|-----------------|--|---------------------|
| Noise level (max): | 39 dB(A) | Number of compressors: | 1 compressor |
| Type of refrigerant: | R600A | Number of independent cooling systems: | 1 |

| | | | |
|-------------------------------|------------------|------------------------------|----------------------|
| Width of the product: | 595 mm | Height of the product: | 2004 mm |
| Depth of the product: | 590 mm | Gross weight: | 69 kg |
| Net weight: | 63 kg | Width of the packed product: | 645 mm |
| Height of the packed product: | 2079 mm | Depth of the packed product: | 628 mm |
| Voltage: | 220-240 V | Frequency: | 50 Hz |
| Product code: | 20010037 | EAN code: | 6921727065445 |