

# RB435N4BWE

Hisense

Freestanding fridge/freezer, White, 336 L



Fresh Crisper



Moisture Fresh Crisper



Precise Electronic Control



Counter Depth

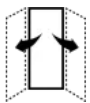

Reversible Door



A-Rated - Energy Efficiency



High-level energy class



Chrome Wine Rack



XXL Door Balcony



Safety Glass Shelves



Low Noise



LED Display

## General information

Construction type:	<b>Freestanding</b>	Energy efficiency class:	<b>E</b>
Noise class:	<b>C</b>	Location of freezing compartment:	<b>Below</b>
Colour of appliance:	<b>White</b>	Door colour:	<b>White</b>
Door material:	<b>Varnished</b>	Door opening:	<b>Right reversible</b>
Number of doors:	<b>2</b>	Type of base:	<b>4 wheels /2 adjustable feet in front</b>
Star rating:	<b>Fresh food, 4-star</b>	Climate classes:	<b>Subtropic, Normal, Subnormal</b>

## Efficiency

Total volume:	<b>336 L</b>	Capacity of cooling compartment:	<b>238 L</b>
Capacity of freezer compartment:	<b>98 L</b>	Freezing capacity in 24 hours:	<b>6 kg</b>
Power cut safe time:	<b>10 h</b>	Annual energy consumption (Aec):	<b>247 kWh</b>

## Control

Type of display:	<b>LED display</b>	Control type:	<b>Electronic behind the door</b>
Cooling compartment defrost mode:	<b>Automatic</b>	Freezing compartment defrost mode:	<b>Automatic</b>

## Features

Crisper pan humidity regulator:	<b>CrispZone drawer with HumidityControl</b>	Eco Mode:	<b>Yes</b>
---------------------------------	--	-----------	------------

## Equipment of refrigerator

Bottle holder:	<b>Wine Rack</b>	Door bottle container:	<b>1 single container without stopper</b>
Trays in refrigerator door:	<b>3 door trays</b>	Fridge compartment illumination:	<b>LED strip on ceiling</b>
Number of glass shelves in fridge compartment:	<b>4 pcs</b>	Cellar (0 zone):	<b>Fresh Crisper</b>

## Equipment of freezer

Ice tray:	<b>1 classic</b>	Freezing compartment:	<b>3 drawers</b>
Freezer compartment illumination:	<b>Without illumination</b>		

## Technical data

Noise level (max):	<b>39 dB(A)</b>	Number of compressors:	<b>1 compressor</b>
Type of refrigerant:	<b>R600A</b>	Number of independent cooling systems:	<b>1</b>

Width of the product:	<b>595 mm</b>	Height of the product:	<b>2004 mm</b>
Depth of the product:	<b>590 mm</b>	Gross weight:	<b>69 kg</b>
Net weight:	<b>63 kg</b>	Width of the packed product:	<b>645 mm</b>
Height of the packed product:	<b>2079 mm</b>	Depth of the packed product:	<b>628 mm</b>
Voltage:	<b>220-240 V</b>	Frequency:	<b>50 Hz</b>
Product code:	<b>20010005</b>	EAN code:	<b>6921727065421</b>