



Philips OLED 8 series  
4K UHD OLED Android  
TV with Ambilight 3-sided

P5 AI perfect picture engine  
Dolby Atmos cinematic sound  
Ambilight 3-sided  
164 cm (65") Android TV



65OLED805

Sophisticated performance. Minimalist design.

## 4K UHD OLED Android TV

Immerse yourself in a sharp, polished picture with natural colors and rich contrast. This slim, elegant Philips 4K OLED TV brings lifelike depth and fluid motion to the content you love. Ambilight completes the picture beautifully.

### Designed to mesmerize.

- Philips OLED TV. This is what lifelike feels like.
- The magic of Ambilight. Only from Philips.
- Muirhead leather-backed remote control with backlit keys.
- Stand height adjusts to accommodate a soundbar.

### Smooth motion. True color. Incredible depth.

- P5 engine with AI. Whatever you watch, a picture so real.
- Dolby Vision and Dolby Atmos. Cinematic vision and sound.
- Major HDR formats. See more of what the director intended.

### Content at your command.

- Android TV. Simply smart.
- Voice control. Google Assistant built-in. Works with Alexa.
- DTS Play-Fi. Multi-room audio.

# PHILIPS

4K UHD OLED Android TV  
P5 AI perfect picture engine Dolby Atmos cinematic sound, Ambilight 3-sided, 164 cm (65") Android TV

65OLED805/12

# Highlights

## Ambilight 3-sided



With Philips Ambilight every moment feels closer. Intelligent LEDs around the edge of the TV respond to the on-screen action and emit an immersive glow that's simply captivating. Experience it once and wonder how you enjoyed TV without it.

## Philips OLED TV



With a Philips OLED TV, you get a wider viewing angle and a uniquely lifelike HDR picture where every scene feels impressively real. Blacks are deeper, colors more vibrant, and details in shadows and highlights are precisely reproduced.

## P5 engine with AI.



Philips P5 processor with AI delivers a picture so real it feels like you could step right into it.

A deep-learning AI algorithm processes images in a manner similar to the human brain. No matter what you're watching, you get lifelike detail and contrast, rich color, and smooth motion.

## Dolby Vision and Dolby Atmos

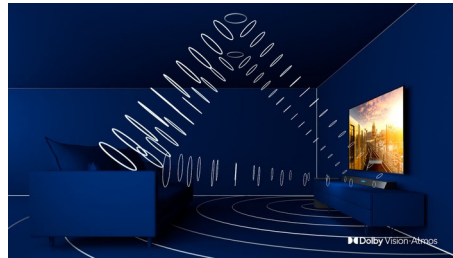

Support for Dolby's premium sound and video formats means the HDR content you watch will look-and sound-gloriously real. Whether it's the latest streaming series or a Blu-Ray disc set, you'll enjoy contrast, brightness, and color that reflect the director's original intentions. And hear spacious sound with clarity, detail, and depth.

## Design

Muirhead leather-backed remote control with backlit keys.

## Android TV

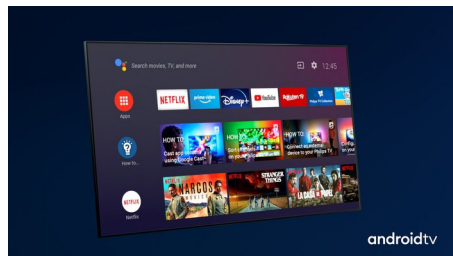

Your Philips Android TV gives you the content you want-when you want it. You can customize the home screen to display your favorite apps, making it simple to start streaming the movies and shows you love. Or pick up where you left off.

## Voice assistant

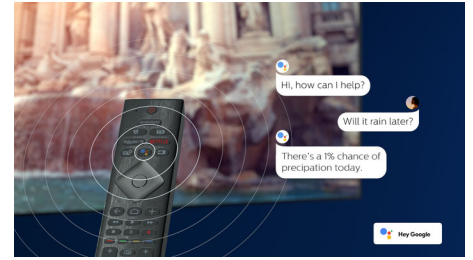

Control your Philips Android TV with your voice. Want to play a game, watch Netflix, or find content and apps in the Google Play store? Just tell your TV. You can even command all Google Assistant-compatible smart home devices, like dimming the lights and setting the thermostat on movie night. Without leaving the sofa. The days of searching for the TV remote are over. Now you can use your voice to control your Philips smart TV via Alexa-enabled devices, like Amazon Echo. Turn your TV on, change the channel, switch to your gaming console and more with Alexa.

## DTS Play-Fi

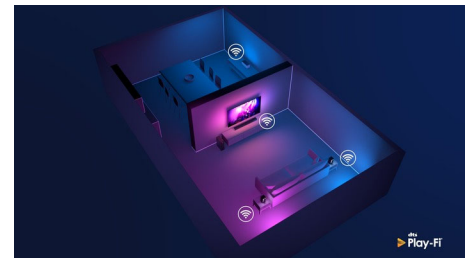

With DTS Play-Fi on your Philips TV you can connect to compatible speakers in any room. Got wireless speakers in the kitchen? Listen to the movie while you make a snack, or keep up with the sports commentary while you get everyone a drink.



# Specifications

## Ambilight

- Ambilight Version: 3-sided
- Ambilight Features: Built in Ambilight+hue, Ambilight Music, Game Mode, Wall colour adaptive, Lounge mode, AmbiWakeup, AmbiSleep

## Picture/Display

- Display: 4K Ultra HD OLED
- Diagonal screen size: 65 inch / 164 cm
- Panel resolution: 3840x2160
- Aspect ratio: 16:9
- Pixel engine: P5 AI Perfect Picture Engine
- Picture enhancement: Ultra Resolution, Wide Color Gamut 99% DCI/P3, Dolby Vision, HDR10+, Perfect Natural Motion, 5700 PPI

## Supported Display Resolution

- Computer inputs on all HDMI: HDR supported, HDR10+/HLG, HDR supported, HDR10/HLG, up to 4K UHD 3840x2160 @60Hz
- Video inputs on all HDMI: HDR supported, HDR10/HLG (Hybrid Log Gamma), HDR10+/Dolby Vision, up to 4K UHD 3840x2160 @60Hz

## Android TV

- OS: Android TV™ 9 (Pie)
- Pre-installed apps: Google Play Movies\*, Google Play Music\*, Google Search, YouTube, Amazon instant video, BBC iplayer, Netflix
- Memory size(Flash): 16GB\*

## Smart TV Features

- Interactive TV: HbbTV
- Program: Pause TV, USB recording\*
- Ease of Installation: Auto detect Philips devices, Network installation wizard, Settings assistant wizard, Device connection wizard
- Ease of Use: One-stop smart menu button, Onscreen usermanual
- Firmware upgradeable: Firmware auto upgrade wizard, Firmware upgradeable via USB, Online firmware upgrade
- Screen Format Adjustments: Basic - Fill Screen, Fit to screen, Advance - Shift, Zoom, stretch, Wide screen
- Remote Control: with Voice, with Key light, with Muirhead leather
- User Interaction: SimplyShare
- Voice assistant\*: Google Assistant built-in, RC with Mic., Works with Alexa

## Processing

- Processing Power: Quad Core

## Tuner/Reception/Transmission

- HEVC support
- Digital TV: DVB-T/T2/T2-HD/C/S/S2
- MPEG Support: MPEG2, MPEG4
- Video Playback: PAL, SECAM
- TV Program guide\*: 8 day Electronic Program Guide
- Signal strength indication
- Teletext: 1000 page Hypertext

## Connectivity

- Number of HDMI connections: 4
- Number of USBs: 2
- Wireless connections: Bluetooth 4.2, Wi-Fi 802.11ac, 2x2, Dual band
- Other connections: Common Interface Plus (CI+), Digital audio out (optical), Ethernet-LAN RJ-45, Headphone out, Satellite Connector, Service connector
- HDMI features: 4K, Audio Return Channel
- EasyLink (HDMI-CEC): Remote control pass-through, System audio control, System standby, One touch play
- HDCP 2.3: Yes on all HDMI

## Multimedia Applications

- Video Playback Formats: Containers: AVI, MKV, H264/MPEG-4 AVC, MPEG-1, MPEG-2, MPEG-4, WMV9/VC1, VP9, HEVC (H.265)
- Subtitles Formats Support: .SRT, .SUB, .TXT, .SMI
- Music Playback Formats: AAC, MP3, WAV, WMA (v2 up to v9.2), WMA-PRO (v9 and v10)
- Picture Playback Formats: JPEG, BMP, GIF, PNG, 360 photo, HEIF

## Power

- Mains power: AC 220 - 240 V 50/60Hz
- Standby power consumption: <0.3W
- Off mode power consumption: N/A
- Ambient temperature: 5 °C to 35 °C
- Power Saving Features: Auto switch-off timer, Light sensor, Picture mute (for radio), Eco mode

## EU Energy card

- EPREL registration numbers: 421959
- Diagonal screen size (inch): 65
- Diagonal screen size (metric): 164

- Energy class for SDR: G
- On mode power demand for SDR: 137 Kwh/1000h
- Energy class for HDR: F
- On mode power demand for HDR: 96 Kwh/1000h
- Networked standby mode: <2.0 W
- Off mode power consumption: n.a.
- Panel technology used: OLED

## Sound

- Audio: Output power : 50 Watt (RMS), 2.1 Channel
- Codec: AC-4, Dolby Atmos, Dolby Digital MS12 V2.3, DTS-HD(M6)
- Speaker configuration: 10Wx2 mid-high speaker, 30W sub-woofer
- Sound Enhancement: 5 Band Equalizer, A.I. Sound, Clear Dialogue, Dolby Atmos, Dolby Bass Enhancement, Dolby Volume Leveler, Night mode, Auto Volume Leveler, Bass Enhancement

## Dimensions

- Box dimensions (W x H x D): 1660.0 x 1002.0 x 174 mm
- Set dimensions (W x H x D): 1448.7 x 829.5 x 58.0 mm
- Set dimensions with stand (W x H x D): 1448.7 x 897.0 x 280.0 mm
- Product weight: 27.9 kg
- Product weight (+stand): 28.4 kg
- Weight incl. Packaging: 36.6 kg
- Stand dimensions (W x D): 792.0 x 280.0 mm
- Adjustable stand height (Max.): 67.8 mm
- Adjustable stand height (Min.): 16.8 mm
- VESA wall mount compatible: 300 x 300 mm



## Connections

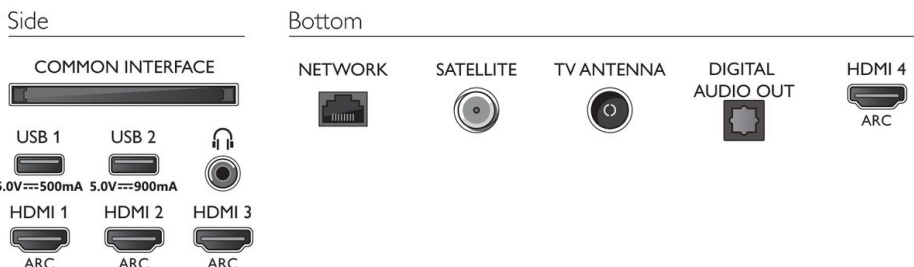

Issue date 2021-09-29

Version: 16.4.1

12 NC: 8670 001 65515  
EAN: 87 18863 02280 1

© 2021 Koninklijke Philips N.V.  
All Rights reserved.

Specifications are subject to change without notice.  
Trademarks are the property of Koninklijke Philips N.V.  
or their respective owners.

[www.philips.com](http://www.philips.com)

\* Memory size (Flash) : 16GB, the actual available disc space may differ (dependant on e.g. (pre-)installed apps, installed operating system, etc.)

\* EPG and actual visibility (up to 8 days) is country and operator dependent.

\* Android App offerings vary per country. For more details please visit your local Google Play Store.

\* The TV supports DVB reception for 'Free to air' broadcast. Specific DVB operators may not be supported. An up to date list can be found in the FAQ section of the Philips support website. For some operators Conditional Access and subscription are required. Contact your operator for more information.

\* Philips TV Remote app and related functionalities vary per TV model, operator, and country, as well as smart device model and OS. For more details please visit: [www.philips.com/TVRemoteapp](http://www.philips.com/TVRemoteapp).

\* Smart TV app offerings vary per TV model and country. For more details please visit: [www.philips.com/smarttv](http://www.philips.com/smarttv).

\* USB recording for digital channels only, recordings may be limited by broadcast copy protection (CI+). Country and channel restrictions may apply.

\* This television contains lead only in certain parts or components where no technology alternatives exist in accordance with existing exemption clauses under the RoHS Directive.